

30<sup>th</sup>  
Anniversary Celebration!

DiaDent<sup>®</sup>

evo fill<sup>™</sup> duo

Cordless Warm Vertical Compaction & Backfill Obturation System

Revolutionize your practice with the new EvoFill<sup>™</sup> Duo cordless obturation system. With an innovative electric motor that prevents hand fatigue, EvoFill Duo offers fast heating and controlled gutta percha extrusion with precise 3D fills and reliable results.

#### EvoFill<sup>™</sup> Backfill Obturation System

- Controlled, precise motorized gutta percha extrusion
- Fast heating 360° swivel cartridge needle
- 3 different temperature settings to control extrusion speed
- Hygienic single-use, fast loading gutta percha cartridge
- No mess, easy clean up

#### EvoPack<sup>™</sup> Vertical Compaction Device

- Innovative LED light-guided condenser
- Save time with instant heating
- Tightly seals all canals including lateral canals
- Adjustable temperature setting and time
- Simple one-button operation

*Revolutionary Evolution...*

*Evo'lution: a process of formation or growth; continuous development of change, progression, metamorphosis.*



Ask your personal dealer representative for detailed pricing and product information. Demo unit is available upon request. Instructional video is available on [www.diadent.com](http://www.diadent.com)

DiaDent Group International  
[www.diadent.com](http://www.diadent.com) | 1.877.342.3368  
Follow us on FACEBOOK



# ROOT CANAL OBTURATION TECHNICAL SEQUENCE

## Vertical Condensation with **EVO pack™**

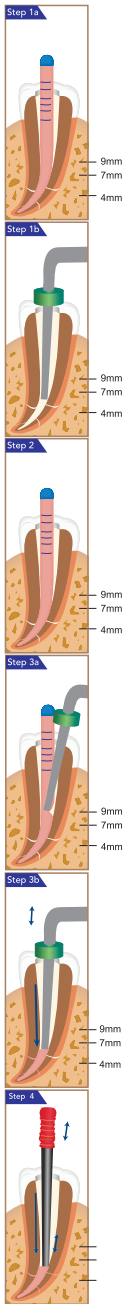

- 1a. Shape the root canal with endo files and determine the working length. Select a master cone that closely matches the apical size.
- 1b. Insert Heating Condenser (EvoPack) into the root canal to the point 4~7mm short of the working length. Move and set the endo stop accordingly.
2. Insert the selected master Gutta Percha cone that is coated with sealer.
- 3a. Place Heating Condenser (EvoPack) in the orifice of the canal and activate EvoPack by pressing the Operation Button. Using the activated Heating Condenser, cut the middle of Gutta Percha cone and downpack the soften material to the point 6~9mm from the apex for about 2 seconds only.
- 3b. Release the Operation Button to allow the Heating Condenser to cool down, while at the same time continue pushing and holding the cooled Heating Condenser to the apex for 8 seconds. This ensures all lateral and accessory canals are filled. Activate the Heating Condenser again by pressing and holding the Operation Button for about 1.5 seconds, compact the Gutta Percha cone to the point 4~7mm of working length.
4. Condense the remaining material using a hand plugger.

## Backfill Obturation with **EVO fill™**

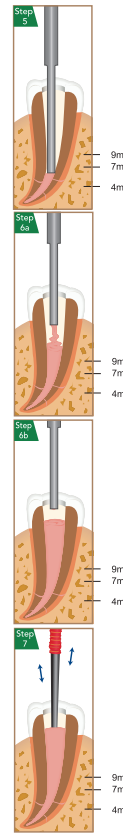

5. Using EvoFill's activated Gutta Percha Cartridge Tip, make contact with the upper part of filled master cone in the canal, transfer heat for 3 to 5 seconds to soften the material.
- 6a. Extrude the melted Gutta Percha into the root canal.
- 6b. Continue flowing while withdrawing the tip from the canal.
7. Use a hand plugger to compact the obturation material.

### • EvoFill™ Duo Complete Kit • (1 YEAR WARRANTY)

Contains: 1 EvoFill Handpiece, 1 Safety Cap, 1 EvoPack Handpiece, 2 Heating Condensers, 1 Dual Charger, 1 Power Adapter & Cord, 1 Scrubbing Brush, 1 Multi-Tool, User Manual.

### • Gutta Percha Cartridge (EvoFill) •

Contains: 20 tips/box



## ORDER INFORMATION

4005-1001	EvoFill Duo Regular Kit
4005-1101	EvoFill Handpiece
4005-1201	EvoPack Handpiece
4005-2010	Gutta Percha Cartridge (20/box)
4005-2020	Charger (for EvoFill & EvoPack)
4005-2060	Power Adapter and Cord
4005-2050	Battery
4005-2070	Heating Condenser XF
4005-2071	Heating Condenser F
4005-2072	Heating Condenser FM
4005-2073	Heating Condenser M
4005-2074	Heating Condenser ML
4005-2075	Heating Condensers Combo F/FM (2/box)
4005-2076	Heating Condensers Assorted XF/ML (5/box)
4005-2080	Multi-Tool
4005-2090	Scrubbing Brush

## SPECIFICATIONS

<b>EvoPack</b>	Size (mm) L x W x H	182 x 25 x 29 mm
	Weight (g)	102 +- 1 g (incl. battery)
	Standby/Auto Power Off	5 min./10 min.
<b>EvoFill</b>	Size (mm) L x W x H	222 x 25 x 29 mm
	Weight (g)	190 +- 1 g (incl. battery)
	Standby/Auto Power Off	5 min./10 min.
<b>Charger</b>	Size (mm) L x W x H	178 x 13 x 82 mm
	Charging time	Approx. 90 minutes
<b>Battery</b>	Size (mm) L x W x H	78 x 25 x 26 mm
<b>Adapter</b>	Input	100~240V, 50/60Hz, 1A
<b>Operating Condition</b>	Temperature	10°C~ 40°C
	Atmospheric Pressure	60~101 kPa
	Humidity	30~85%